

# SM-Exx ELECTROLYTIC GOLD SCALE INHIBITOR

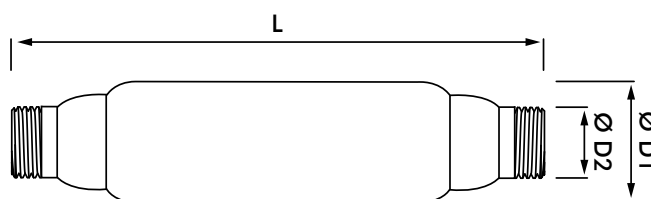

## DESCRIPTION

Limescale inhibitors (sometimes called physical water conditioners or physical water treatment devices) is a term generally used to describe products that are designed to prevent lime-scale build-up on cylinder elements and/or heat exchange surfaces in boilers when hard water is heated.

Scalemaster® Electrolytic Limescale Inhibitors prevent limescale build-up by adding a small trace of zinc to the water. This has the effect of suppressing limescale formation by bonding to the dissolved calcium ions which then require more energy for precipitation. Any micro-crystals which form are then washed away by the water flow rather than adhering to element/heat-exchanger surfaces.

Laboratory research has shown a relationship between the amount of zinc dissolved and the reduction in limescale precipitation achieved, Scalemaster® Electrolytic Limescale Inhibitors incorporate patented technology to boost the supply of zinc. In independent tests, application of the Scalemaster® electrolytic technology typically extends boiler life by 50% in hard water areas by preventing limescale precipitation.

Connect into pipework in the plant room or entry point of the building.

## INSTALLATION

**For individual appliance or whole building protection.**

- For whole building plumb in just after supply pipe stop cock
- Operating temperature 4 - 40°C
- Do not allow to freeze
- Maximum operating pressure 800kPa

## MODELS

Model	L	D1	D2 (BSP)	Max Flow Rate
SE-M15	154mm	35mm	15mm	32 (L/min)
SE-M20	150mm	35mm	20mm	36 (L/min)
SE-M25	157mm	43mm	25mm	63 (L/min)



Melbourne (Head Office)

MACDONALD INDUSTRIES AUSTRALIA sales@macdonaldindustries.com.au  
 macdonaldindustries.com.au